

47TH Annual Benthic Ecology Meeting

March 27-30, 2018 Corpus Christi, TX

Harte Research Institute for Gulf of Mexico Studies
Texas A&M University – Corpus Christi



SPONSORS



WELCOME FROM THE PRESIDENT

Welcome to the 47th Annual Benthic Ecology Meeting!

The 47th Benthic Ecology Meeting, hosted by Texas A&M University – Corpus Christi, takes place at the Omni Hotel from March 26th – 30th, 2018. This is one of the largest meetings of marine biologists in the USA with over 320 registered participants, including many students as well as scientists from academe, government, non-profits, and industry. We look forward to a great meeting! Please take a moment to review the meeting code of conduct to ensure everyone has a safe, fun, and productive meeting.

The meeting begins on Monday with a MarineGEO workshop, followed by workshops and a field trip on Tuesday. The opening reception and registration will take place Tuesday evening. On Wednesday, we are honored to have Dr. Jeffrey Levinton deliver a plenary talk to kick off the meeting presentations.

As a new twist this year, we are conducting the poster session off site at the Texas State Aquarium during the morning. The aquarium added a new building last year and is one of the premier destinations in the City. Admission to the aquarium exhibits, brunch, and transportation will be provided to all registrants. We elected to do the poster session in the morning so that posters can be showcased instead of presented late in the evening when folks may be tired from the oral presentations.

Friday night, the meeting concludes with an awards banquet at Brewster Street Icehouse and features a fajita buffet with live music by Jake Ward, a local band that is quickly making a national name for themselves, followed by Five Card Draw, the Brewster Street house band. Although the banquet will end at 10:30, you may stay at Brewster Street until closing without paying extra.

The TAMUCC crew, especially Paul Montagna and the Harte Institute Staff, worked very hard for the past year to help make the meeting successful. Please be sure to thank them and the other TAMUCC crew as well as our student volunteers. Have a great BEM 2018!

- Lee Smee, 2017-18 BEM President and Host

TABLE OF CONTENTS

SPONSORS.....	0
WELCOME FROM THE PRESIDENT	i
TABLE OF CONTENTS.....	ii
GENERAL CONFERENCE INFORMATION	1
BEM 2018 CONFERENCE COMMITTEE.....	4
BEM SOCIETY GOVERNING BOARD.....	4
PRE-MEETING FIELD TRIP & WORKSHOPS	5
PLENARY SPEAKER BIOSKETCH	7
WEEK AT A GLANCE	8
SESSIONS	9
LOCATIONS OF PREVIOUS BENTHIC MEETINGS.....	27
BEMS CODE OF CONDUCT	29
BEM 2018 CONFERENCE NOTES	30
VENUE MAPS.....	34

GENERAL CONFERENCE INFORMATION

Venue:

- Omni Hotel, 900 N Shoreline Blvd, Corpus Christi, TX 78401, telephone +1 361-887-1600.
- All activities will take place on the second floor, and a floor plan is on the back cover of the program book.

Airport transfers:

- Omni Hotel guests can call the hotel to schedule airport pick up, or call from the airport. Call (361) - 887-1600

Parking:

- \$5 per day for self-parking in the hotel garage.
- Complimentary parking for the outdoor lot on Water Street.

Registration:

- Located in the Corpus Christi Ballroom Foyer (labeled Pre-Function area on floor plan).
- The registration schedule is as follows:

Tuesday (3/27) 4:00 PM to 7:00 PM

Wednesday (3/28) 7:00 AM to 5:00 PM

Thursday (3/29)..... 7:00 AM to 9:00 AM and 1:30 PM to 5:00 PM

Friday (3/30)..... 7:00 AM to 5:00 PM

Ribbon Badge Color Codes:

- BLACKPresident
- BLUEHost Committee
- GREENBenthic Ecology Meeting Society Board Member
- REDSession Chair
- ORANGE ...BEM 2018 Volunteer Staff

BEM 2018 Logo:

- The BEM 2018 Logo created by Elizabeth Robinson, Louisiana State University, of “Out With the Tide Art” <http://www.outwiththetideart.com/>, outwiththetideart@gmail.com, @outwiththetideart

Abstracts:

- The abstract book will not be printed, but is available on the BEM website at: <http://www.bemsociety.org/bem-2018-program.html>

Welcome Reception:

- There is a Welcome reception from 5:00 – 7:00 PM on Tuesday, March 27.

WiFi:

- Connect to the SSID (service set identifier) “Omni Meeting”
- User Name: bem2018
- Password: bem2018

Oral Sessions:

- Load your talks prior to your session in the oral presentation upload room (boardroom on the second floor).
- Presentations must be loaded at least one session in advance
- Plan on 12 minutes of speaking and 3 minutes of questions and discussion.
- Timers: green light is on for 12 minutes, yellow light for 3, red light is on at 15 minutes, and blinking red light starts after 30 seconds over time limit.

Poster Session:

- One session Thursday morning at the Texas State Aquarium (TSA) from 9:00 AM – 1:00 PM.
- Buses will be available on the Shoreline Drive side of the lobby starting at 8:45 AM, and will loop from the Omni to TSA from 8:45 to 9:45 AM.
 - Poster presenters – please board a bus to TSA by 8:45 AM.
 - Non-presenters – please allow poster presenters to board buses first.
- Poster set-up will be from 9:00 AM 9:30 AM
- Poster presentation session will begin at 9:30 AM
 - Presenters with odd poster numbers should be at their posters from 9:30 AM – 10:45 AM
 - Presenters with even poster numbers should be at their posters from 10:45 AM – 12:00 PM.
- Buses will loop from TSA to the Omni from 12:00 PM to 1:00 PM.

Presentation Awards for Students:

- BEM 2018 will feature four awards.
 - 1) Best oral presentation
 - 2) Best poster presentation
 - 3) People’s choice oral presentation
 - 4) People’s choice poster presentation
- Everyone will receive two ballots in their registration packet to vote for student “people’s choice award” presentations, 1 poster and 1 oral. We will have a ballot box at the registration table for these submissions

Awards Banquet:

- The Presentation Awards will be announced at the Awards Banquet at Brewster Street Ice House on Friday evening.
- Buses will be available on the Shoreline Drive side of the lobby starting at 6:30 PM.
- Buses will run continuous loops.
- The last bus will leave Brewster Street at 11:30 PM
- You must show your conference badge for admission to Brewster Street, and to obtain a wrist band and food/drink tickets.
- Arrival and appetizers at 6:30 PM
- Dinner will be served at 7:00 PM
- Awards will be announced at 7:45 PM
- The Jake Ward Band will play at 8:00 PM
- 5-Card Draw will play at 9:00 PM

Conference Catering and Menus:

- Omni:
 - Welcome Reception: Popcorn, Roasted Peanuts, Dill Pickles, Ballpark Nachos, Cracker Jacks, Mini Corn Dogs with Condiments, Cheese Quesadillas, and 2 beer or wine or soft drinks.
 - Continental Breakfast: Orange and Grapefruit Juice, Croissant and Danish, Medium roast coffee and Herbal Teas.
 - Morning Breaks: Medium roast coffee, Decaffeinated Coffee, Coffee Flavorings, Chocolate Shavings, Whipped Cream, Cinnamon Sticks, Biscotti, and Herbal Teas.
 - Afternoon Breaks: Assorted Soft Drinks, Iced Tea.
- Texas State Aquarium:
 - Brunch: Coffee, Water, Fruit juice, and Hot tea; Breakfast Tacos (bacon & egg, chorizo & egg, potato & egg, bean & cheese) with salsa; Fresh fruit; and Pastries.
- Brewster Street Ice House:
 - Appetizer: Chili Con Queso with Chips.
 - Dinner: Fajita Station - beef and chicken fajitas served with flour tortillas, fiesta rice, refried beans, guacamole, shredded cheese, lettuce, sour cream, and salsa fresca.
 - Beverages: 3 Brewster Bucks, each redeemable for a well drink, any domestic bottle, any draft beer, house glass of wine, small margarita, or soft drink.

Maps:

- Omni Hotel floorplan is on the back cover.
- Locations of downtown restaurants is on the back inside cover.

BEM 2018 CONFERENCE COMMITTEE

Conference Chair (BEMS President): Lee Smee

Conference Co-Chairs: Paul Montagna, Jennifer Pollack, Ed Proffitt

Program Committee: Donna Devlin (Chair), Elani Morgan

Student Judging Committee: Jennifer Pollack (Chair), Terry Palmer

Volunteers Committee: Carolyn Weaver (Chair), Michael Reuscher

BEM SOCIETY GOVERNING BOARD

The Benthic Ecology Meeting (BEM) Society is a 501 (c) (3) non-profit organization that was formed in 2012 for the purpose of exchange of scientific information on benthic ecosystems and to foster the next generation of benthic biologists. This is accomplished by holding an annual meeting. Participation in a BEM confers membership status. BEM is managed by a Governing Board consisting of officers and up to five members-at-large. The President is organizer of the annual BEM, and the President-elect is organizer of the next meeting. The BEM website is located at <http://www.bemsociety.org/> and the constitution and bylaws are available at <http://www.bemsociety.org/about-bems1.html>.

The Current BEMS Board, 2017-2018

Lee Smee, *President*

Patrick Gagnon, *President-elect*

Keith Walters, *Past-president*

Ladd Johnson, *Treasurer*

Donald Behringer, *Secretary*

Mark Butler, Nicole Fogarty, Brad Peterson; *Members-at-large*

Past BEMS Board Presidents

2016-2017: Keith Walters, *Coastal Carolina University*

2015-2016: David Carlon, *University of Florida*

2014-2015: Ladd Johnson, *L'Université Laval*

2013-2014: Matthew Gilg, *University of North Florida*

2012-2013: Daniel Gleason, *Georgia Southern University*

2011-2012: Mark Butler, *Old Dominion University*

2010-2011: John Valentine, *Dauphin Island Sea Laboratory*

PRE-MEETING FIELD TRIP & WORKSHOPS

Field Trip to Padre Island National Seashore and Laguna Madre Field Station

Donna Devlin donna.devlin@tamucc.edu and Ed Proffitt, Ed.Proffitt@tamucc.edu, Department of Life Sciences, Texas A&M University – Corpus Christi

Schedule: 8:00 am – 3:30 pm, **meet in lobby of the Omni Hotel**

Abstract: Field trip to the unique, beautiful and biologically elegant Laguna Madre and associated Padre Island National Seashore. This trip will begin with a boat tour of the Laguna Madre and docking and shore walk at the TAMUCC Laguna Madre Field Station. After the Laguna Madre, we will go by van to the Padre Island National Seashore for a guided nature walk along trails, and then culminate with a beach walk. Water will be provided. We will stop at a local waterfront restaurant for a late lunch (on your own).

Bring: Sunscreen, hat, appropriate foot ware.

Statistical Methods Using R: Univariate Analyses

Peter Petraitis, ppetrait@sas.upenn.edu, Professor of Biology, Emeritus, University of Pennsylvania

Schedule: Half-day session, 9:00 am - 12:00 pm, Laguna Madre Room

Abstract: How to do ANOVAs (including factorial designs, nested designs, and mixed models), linear and multiple regression and planned comparisons. Differences between type II and type III sums of squares, the differences between mixed models based on expected mean squares and REML, and differences between how F-ratios for mixed models are formed and what is found in JMP, SAS and R. Workshop assumes basic knowledge of R; for example, how to import csv files and run simple functions such as `aov()` and `lm()`. Examples will be run in RStudio although participants are welcome to use the native R environment. Data files and R scripts will be provided.

Bring: Your laptop already loaded with R, RStudio, and the following packages: `car`, `effects`, `lme4`, and `multcomp`

Statistical Methods Using R: Multivariate Analyses

Peter Petraitis, ppetrait@sas.upenn.edu, Professor of Biology, Emeritus, University of Pennsylvania

Schedule: Half-day session, 1:30 am - 5:00 pm, Laguna Madre Room

Abstract: How to do multivariate methods including MANOVA, repeated measures, and an introduction to the `vegan` package, which does everything that is found in PRIMER (e.g., nMDS, PERMANOVA, constrained analysis of proximities, etc.). Workshop assumes basic knowledge of R; for example, how to import csv files and run simple functions such as `aov()` and `lm()`. Examples will be run in RStudio although participants are welcome to use the native R environment. Data files and R scripts will be provided.

Bring: Your laptop already loaded with R, RStudio, and the following packages: `car`, `effects`, `lme4`, `multcomp`, and `vegan`.

Scientific Writing and Publishing Boot Camp

Paul Montagna, paul.montagna@tamucc.edu, Endowed Chair, Harte Research Institute, Texas A&M University-Corpus Christi; Co-Editor in Chief, Estuaries and Coasts

Schedule: Half-day session, 1:30 pm - 5:00 pm, Copano Room

Abstract: One of the most difficult things students (and young professors) face is getting it all down on paper and eventually into print. However, this gets much easier over time if you gain experience. So, why not take a short cut and learn from a seasoned pro, who has already made all the mistakes and climbed that steep learning curve. The topics covered will include: 1) getting organized and basic writing principles, 2) tips for preparing figures and tables, 3) advanced tricks for using Microsoft Word, 4) turning a thesis or dissertation into a publishable article, and 5) navigating the science journal landscape and submission process.

Bring: Your laptop, and a writing sample or draft manuscript.

PLENARY SPEAKER BIOSKETCH

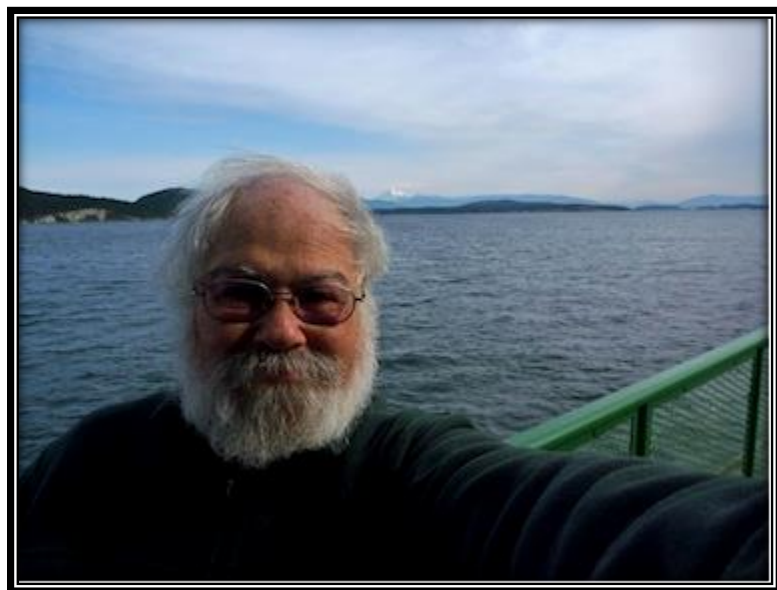

Jeffrey Levinton is a Distinguished Professor in the Department of Ecology and Evolution at Stony Brook University. He received his PhD from Yale University in 1971 and in same year joined the faculty at Stony Brook. Levinton was a Guggenheim Fellow, a Fulbright Senior Scholar and is the author of a major textbook in marine biology and a monograph on macroevolution. He has served as an editor for *The American Naturalist*, *Ecology*, *Ecological Applications*, and was head of the Hudson River Fund Panel of the

Hudson River Foundation. He has been a visiting professor at University of Aarhus, Uppsala University, University of Cambridge, and University of Sydney.

Levinton has broad interests not only in trophic ecology, functional morphology, soft-bottom benthic ecology, but also in macroevolution and evolutionary aspects of marine ecological processes. Over the years, he has worked on feeding selectivity in suspension-feeding bivalves, the evolution of resistance to toxic substances and physiological adaptation of growth strategies to temperature regimes, the role of sexual and natural selection in the morphological evolution of fiddler crabs, and the timing of the divergence of the animal phyla and evidence against the Cambrian explosion hypothesis. While many of his students have worked on related research topics, others have worked on grazing in coral reefs, chemical defense in tunicates, rocky shore ecology and paleoecology of dinosaurs.

He has published more than 150 papers and recently published the fifth edition of the textbook *Marine Biology*, Oxford University Press. He is the author of the Marine Biology Web Page, MBWEB.

WEEK AT A GLANCE

MONDAY MARCH 26	
9:00 - 5:00	WORKSHOP - MarineGeo (invitation only) - Aransas Room

TUESDAY MARCH 27	
8:30 – 3:00	FIELD TRIP - Padre Island National Seashore & Laguna Madre – Lobby Omni Hotel
8:30 - 5:00	WORKSHOP - MarineGeo - (invitation only) - Aransas Room
9:00 - 12:00	WORKSHOP - Statistical Methods Using R: Univariate Analyses - Laguna Madre Room
12:00 - 1:30	LUNCH - On Your Own
1:30 - 5:00	WORKSHOP - Statistical Methods Using R: Multivariate Analyses - Laguna Madre Room
1:30 - 5:00	WORKSHOP - Scientific Writing and Publishing Boot Camp - Copano Room
4:00 - 7:00	REGISTRATION - Corpus Christi Ballroom Foyer
5:00 - 7:00	WELCOME RECEPTION -Corpus Christi Ballroom B/C

WEDNESDAY MARCH 28			
7:00 - 8:30	CONTINENTAL BREAKFAST - Corpus Christi Ballroom B/C		
7:00 - 5:00	REGISTRATION - Corpus Christi Ballroom Foyer		
8:30 - 10:00	PLENARY - Nueces Ballroom A/B		
10:00 - 10:30	BREAK - Corpus Christi Ballroom B/C		
	Corpus Christi Ballroom A	Nueces Ballroom A	Nueces Ballroom B
10:30 - 12:00	Anthropogenic Impacts I	Community Ecology I	Biological Invasions I: Molecular
12:00 - 1:30	LUNCH - On Your Own		
1:30 - 3:15	Anthropogenic Impacts II	Community Ecology II	Biological Invasions II: Interactions
3:15 - 3:45	BREAK - Corpus Christi Ballroom B/C		
3:45 - 5:45	Ecophysiology, Arctic Ecosystems	Community Ecology III	Bi In III: Pathogens, Climate, Seagrass

THURSDAY MORNING MARCH 29			
7:00 - 5:00	REGISTRATION - Corpus Christi Ballroom Foyer		
9:00 - 1:00	POSTER SESSION & BRUNCH - Texas State Aquarium - Buses		
1:00 - 1:30	BREAK - On Your Own		
	Corpus Christi Ballroom A	Nueces Ballroom A	Nueces Ballroom B
1:30 - 3:15	Reef Ecol. I: Disturb., Hurricanes, Shifts	Sustainable Fisheries	Trophic Relationships
3:15 - 3:45	BREAK - Corpus Christi Ballroom B/C		
3:45 - 5:45	Reef Ecol. II: Disease, Manag., Genetics	Molecular Ecology	Ecosystem Functioning & Stability

FRIDAY MARCH 30			
7:00 - 8:30	CONTINENTAL BREAKFAST - Corpus Christi Ballroom B/C		
7:00 - 5:00	REGISTRATION - Corpus Christi Ballroom Foyer		
	Corpus Christi Ballroom A	Nueces Ballroom A	Nueces Ballroom B
8:30 - 10:00	Reef Ecology III: Community Ecology	Biodiversity	Ecosystem Services, Deep Sea Biol.
10:00 - 10:30	BREAK - Corpus Christi Ballroom B/C		
10:30 - 12:00	Reef Ecology IV: Larval Recruitment, Fish	Habitat Sustainability, Restoration I	Behavior
12:00 - 1:30	LUNCH - On Your Own		
1:30 - 3:15	Macroecology, Chem. Ecol., Life History	Habitat Sustainability, Restoration II	Evolution, Populations, Genomics
3:15 - 3:45	BREAK - Corpus Christi Ballroom B/C		
3:45 - 5:45	Recruitment, Larval Ecology	Climate Change	Conservation Management
7:00 - 10:00	AWARDS BANQUET/BAND - Brewster Street Icehouse - Buses		

SESSIONS

WEDNESDAY (MARCH 28) AT A GLANCE			
7:00 - 8:30	CONTINENTAL BREAKFAST CORPUS CHRISTI BALLROOM B/C		
7:00 - 5:00	REGISTRATION CORPUS CHRISTI BALLROOM FOYER		
8:30 - 9:00	WELCOME & BUSINESS MEETING NUECES BALLROOM A/B		
9:00 - 10:00	PLENARY NUECES BALLROOM A/B		
10:00 - 10:30	BREAK CORPUS CHRISTI BALLROOM B/C		
	Corpus Christi Ballroom A	Nueces Ballroom A	Nueces Ballroom B
10:-12:00	Anthropogenic I Impacts	Community Ecology I	Biological Invasions I: Molecular
12:00 - 1:30	LUNCH ON YOUR OWN		
1:30 - 3:15	Anthropogenic Impacts II	Community Ecology II	Biological Invasions II: Interactions
3:15-3:45	BREAK CORPUS CHRISTI BALLROOM B/C		
3:45-5:45	Ecophysiology/Arctic Ecosystems	Community Ecology III	Biological Invasions III: Pathogens/ Climate/Seagrass

WEDNESDAY MARCH 28 - MORNING (8:30 – 10:00)	
7:00- 6:00	REGISTRATION CORPUS CHRISTI BALLROOM FOYER
7:00 - 8:30	CONTINENTAL BREAKFAST CORPUS CHRISTI BALLROOM B/C
	NUECES BALLROOM A/B
8:30 - 9:00	WELCOME PLENARY SESSION WELCOME ADDRESS: Lee Smee BUSINESS MEETING: BEMS Board
9:00 - 10:00	PLENARY PRESENTATION INTRODUCTION by Peter Petraitis PLENARY SPEAKER: Jeffery Levinton Sex on a patch of hot sand: phylogenetic background, biogeography, biomechanical function and thermal-hydric stress
10:00 - 10:30	BREAK CORPUS CHRISTI BALLROOM B/C

WEDNESDAY MARCH 28 - MORNING (10:30-12 NOON)			
Room	CORPUS CHRISTI BALLROOM A	NUECES BALLROOM A	NUECES BALLROOM B
Session	Anthropogenic Impacts I	Community Ecology I	Biological Invasions I: Molecular
Chair	Don Behringer	Jeb Byers	Paul Bologna
10:30 - 10:45	Cannizzo, Z. J. , Lang, S. Q., Griffen, B. D. Man-made docks provide a better reproductive habitat than the surrounding saltmarsh for the range-expanding mangrove tree crab (<i>Aratus pisonii</i>)	Harris, R. D.* , Byers, J. E. Which came first, <i>Spartina</i> or the oyster reef: elucidating spatial distribution patterns of two ecosystem engineers	Restaino, D.* , Bologna, P., Gaynor, J. J. Morphological and molecular variations in the invasive hydrozoan, <i>Gonionemus vertens</i>
10:45 - 11:00	Gül, M. R.* , Griffen, B. D. Burrowing behavior and energy requirements of ghost crabs, <i>Ocypode quadrata</i> , under anthropogenic pressure	Smith, R. S.* , Byers, J. E., Shifting ranges and interactions: how does saltmarsh wrack affect mangrove establishment and growth?	Bologna, P. , Gaynor, J., Restaino, D. The Ellis Island effect: invasive species in the Mid-Atlantic
11:00 - 11:15	Robinson, E.* , Rabalais, N., Gastropod and bivalve community assemblage in Louisiana salt marshes three years after the DWH oil spill	Reustle, J. W.* , Smee, D. L., Cloudy with a chance of mesopredator release: sensory interference alleviates top down control in estuaries	Cipparone, H.* , Carlon, D. B. Wild crabs of the North: optimal prey selection varies between genetic lineages of the European green crab (<i>Carcinus maenas</i>)
11:15 - 11:30	Rohal, M. , Escobar-Briones, E., Montagna, P., Romero, I., et al. How quickly will the deep sea ecosystem recover from the 2010 DWH oil spill? Lessons learned from the 1979 Ixtoc-1 oil well blowout event	Byers, J. E. , Holmes, Z. C., Malek, J. C. Contrasting complexity of adjacent habitats influences the strength of cascading predatory effects	Walkes, S.* , Carlon, D. B. The effects of mitochondrial genotype on the behavioral response to temperature stress in European green crabs <i>Carcinus maenus</i>
11:30 - 11:45	Jennings, L. , Behringer, D. C., Baker, P. K. Temporal and spatial variability of the epibenthic invertebrate communities inhabiting ridge-swale complexes along the South Atlantic Bight	Rogers, T. L.* , Gouhier, T. C., Kimbro, D. L. Temperature-dependency of intraguild predation between native and invasive crabs	Van Deusen, V.* , Carlon, D. B., Kingston, S. E. A next generation approach to understanding diet of the European green crab <i>Carcinus maenas</i> in the Gulf of Maine.
11:45 - 12:00	Gendron, L., Merzouk, A., Bergeron, P., Johnson, L. E. Managing disturbance: the response of a dominant intertidal seaweed <i>Ascophyllum nodosum</i> to different frequencies and intensities of harvesting	Prentiss, C. L.* , Hoffbeck, C. A., Hill, M. S., Weisz, J. B. Potential niche partitioning among sponge species in the lower Florida Keys	Selwyn, J. D., Johnson, J. E., Downey-Wall, A. M., Bynum, A. M., Hamner, R. M. , et al. One fish, ten fish...how many red lionfish colonized the Atlantic?
12:00 - 1:30	LUNCH On Your Own		

WEDNESDAY MARCH 28 - AFTERNOON (1:30-3:15)			
Room	CORPUS CHRISTI BALLROOM A	NUECES BALLROOM A	NUECES BALLROOM B
Session	Anthropogenic Impacts II	Community Ecology II	Biological Invasions II: Interactions
Chair	Chris Patrick	Keith Walters	Stephen Ratchford
1:30 - 1:45	Patrick, C. J. , Lister, J. Nutrient loads explain spatial checker boarding of oysters and seagrass along the US Gulf of Mexico coastline	Zhang, Y. S.* , Silliman, B. R. A facilitation cascade in seagrass beds enhances community diversity	Jurgens, L. , Ruiz, G., Torchin, M. E., Freestone, A. L. Sensitivity of benthic invaders to predation and disturbance across a latitudinal gradient
1:45 - 2:00	Hanley, T. C. , Bowen, J. L., Kearns, P. J., Hughes, A. R. Effects of nutrient enrichment on salt marsh production: A field reciprocal transplant experiment with <i>Spartina alterniflora</i>	Cimon, S., Cusson, M. , Non-additive effects of multiple disturbances and stresses on benthic eelgrass communities	Roy, M. S.* , Johnson, D. S., Byrnes, J. E. K. Density dependent effects of a range expanding fiddler crab (<i>Uca pugnax</i>) on ecosystem functioning in New England salt marshes
2:00 - 2:15	Cuddy, M. R.* , Dunton, K. H. Isoscape and stoichiotope patterns in the dominant seagrasses of the lower Laguna Madre, TX	Schmidmayer, P.* , Archambault, P., McKindsey, C. W., Cusson, M. The role of habitat-forming species along an environmental stress gradient in intertidal communities.	Gribben, P. , Poore, A., Thomsen, M., Wright, J. Positive interactions and invasion success: a biogeographic test across native and invasive ranges
2:15 - 2:30	Cashin, M. J.* , Brown, M. Using GIS to identify SAV and oyster risks in relation to water treatment plants and dead zones within Chesapeake Bay, MD	Walters, K. The ability to describe allometric differences in functional morphology among saltmarsh plant species	Kinney, K. A. , Mell, A. C., Pintor, L. M., Byers, J. E. Does density-dependent predation on a non-native prey facilitate its escape from natural enemies?
2:30 - 2:45	Palmer, T. A. , Montagna, P. A., Hyde, L. J., Sweet, S. T., et al. Long-term changes in macrobenthic communities in contaminated sediments and epifauna bioaccumulation adjacent to McMurdo Station, Antarctica	Zerebecki, R. A.* , Hanley, T. C., Sotka, E. E., Hughes, A. R. Testing for local adaptation across short and tall growth forms of <i>Spartina alterniflora</i>	Crosby, C.* , Pintor, L. M., Byers, J. E. The role of individual learning in the consumption of the non-native green porcelain crab by native crab predators
2:45 - 3:00	Robbins, J. , Figueiredo, J., Gilliam, D. S., Miller, M. W. Effects of ocean warming, increased sedimentation, and parental genotype on the post-settlement survival and growth of <i>Acropora cervicornis</i>	Noto, A. E. , Shurin, J. B., Hechinger, R. Insect herbivores in salt marshes drive geographic variation in the strength of plant-plant competition	Popp, T.* , Wilber, D. Population dynamics and reproductive biology in an invasive population of the green porcelain crab, <i>Petrolisthes armatus</i>
3:00 - 3:15	Beatty, D. S.* , Valayil, J. M., Clements, C. S., Stewart, F. J., Ritchie, K. B., Hay, M. E. Does reef state alter coral chemical defense and microbiomes?	Marco-Mendez, C. , Ferrero-Vicente, L. M., Heck, K. L. Feeding preference and foraging impact of wintering waterfowl on submerged aquatic vegetation in upper Mobile Bay	Ratchford, S. , Arnold, L. Invasive seagrass <i>Halophila</i> hides anemone shrimp cleaning stations?
3:15 - 3:45	BREAK CORPUS CHRISTI BALLROOM B/C		

47th Annual Benthic Ecology Meeting Program

Bold is presenting author. Only first four coauthors listed. * Is judged in student presentation competition.

WEDNESDAY MARCH 29 - AFTERNOON (3:45-5:45)			
Room	CORPUS CHRISTI BALLROOM A	NUECES BALLROOM A	NUECES BALLROOM B
Session	Ecophysiology/Arctic Ecosystems	Community Ecology III	Biological Invasions III: Pathogens/Climate/Seagrass
Chair	Shrey Patel	Pat Gagnon	John Valentine
3:45 - 4:00	Griffen, B. D. Polar bear energetics when the benthos gets pulled out from under them	Pusack, T. , Kimbro, D. L. ,White, J. W., Stallings, C. D. Predation on oysters is inhibited by acutely intense or chronically mild low salinity events	Bojko, J. The role of pathogens in aquatic crustacean invasions
4:00 - 4:15	Hardegree, M.* , Effect of climate on estuarine benthos at regional scales along the Texas coast	Repetto, M. F.* , Ruiz, G. M., Torchin, M. E., Freestone, A. L. Spatial and temporal variability in consumption rates underlie stronger predation in the tropics	Fowler, A. E. , Blakeslee, A. M. H., Canning-Clode, J., Repetto, M. F., et al. A synthesis of the marine live bait trade as a vector for species invasions
4:15 - 4:30	Jones, H.* , La Peyre, M., La Peyre, J., Casas Liste, S., et al. Effects of temperature and salinity on the eastern oyster, <i>Crassostrea virginica</i>	Goeke, J. A.* , Armitage, A. R. Effects of mangrove encroachment on fiddler crab diets: an assessment of preference and food quality	Blakeslee, A. M. H. , Barnard, R. B., Matheson, K., McKenzie, C. H. Parasites and invasions: a case study of parasite spread in two Newfoundland bays
4:30 - 4:45	Zimmermann, D.* , Withers, K., Beseres Pollack, J. Effects of extreme freshwater events and <i>Perkinsus marinus</i> on <i>Crassostrea virginica</i> stress response	Bonfim, M.* , Freestone, A. L. Latitudinal variation in post-disturbance recovery in a marine system	Canning-Clode, J. , Ramalhosa, P., Castro, N., Schäfer, S., et al. Marine invasions in the island ecosystem of Macaronesia: current status and its interplay with climate change
4:45 - 5:00	Dawson, C. J.* The response to disturbance by the annual canopy-forming fucoid, <i>Stephanocystis osmundacea</i>	Stelling-Wood, T.* , Gribben, P.E., Navarro-Barranco, C., Poore, A.G.B. Small- and large-scale variation in macroalgae morphology along a latitudinal gradient	Jerris, K.* , Turner, T. The potentially amplified expansion of the invasive seagrass <i>Halophila stipulacea</i> in the U.S. Virgin Islands because of hurricanes Irma and Maria
5:00 - 5:15	Muth, A.* , Dunton, K. H. Arctic crustose coralline algae and the effects of salinity on physiology, distribution, and their ecological function	Pruett, J. L.* , Weissburg, M. J. Hydrodynamic physical and sensory stressors affect the relative importance of predator consumptive and non-consumptive effects	Martin, C. W. , Valentine, J. F. Invasive Eurasian milfoil (<i>Myriophyllum spicatum</i>) in northern Gulf of Mexico estuaries: reviewing a decade of research on invasion dynamics and food web effects
5:15 - 5:30	Grimes, C.* , Schulze, A. Oxygen uptake and branchiae comparison of the bearded fireworm under low oxygen conditions	Bartholomew, A. Dimensionless indices of habitat complexity: 20 years of results	Alford, S. B.* , Rozas, L. P. Nonnative doesn't always mean negative: effects of Eurasian watermilfoil on nursery habitat quality for estuarine nekton in Louisiana
5:30 - 5:45	Patel, S.* , Spillmann, C. M., Wang, C., Schultzhause, J., et al. Building a barnacle cement protein profile using immunohistochemistry	Ziegler, M.* , Weaver, C. A., Proffitt, C. E. Black mangrove seedling survival and growth rates in different salt marsh habitats under moderate and hypersaline conditions	Chappell, S. , Hotchkin, C., Bort, J. Underwater acoustic camera surveillance of pile driving associated with Navy proposed actions in the Mid-Atlantic region

THURSDAY (MARCH 29) AT A GLANCE			
8:00 – 9:00	REGISTRATION CORPUS CHRISTI BALLROOM FOYER		
8:45 – 9:45	Bus transportation to Poster Session: Aquarium		
9:00 – 1:00	POSTER SESSION TEXAS STATE AQUARIUM Presenters for Odd Poster Numbers should be at Posters 9:30-10:45 Presenters for Even Poster Numbers should be at Posters 10:45-12:00		
9:00 – 11:00	BRUNCH TEXAS STATE AQUARIUM		
1:00 – 1:30	Bus transportation to Oral Sessions: Omni Hotel		
1:30 – 5:00	REGISTRATION CORPUS CHRISTI BALLROOM FOYER		
	Corpus Christi Ballroom A	Nueces Ballroom A	Nueces Ballroom B
1:30 – 3:15	Reef Ecology I: Disturbance/ Hurricanes/ Community Shifts	Sustainable Fisheries	Trophic Relationships
3:15 -3:45	BREAK CORPUS CHRISTI BALLROOM B/C		
3:45 – 5:45	Reef Ecology II: Disease/ Management/ Genetics	Molecular Ecology	Ecosystem Functioning & Stability

THURSDAY MARCH 29 - MORNING POSTER SESSION (9:00–12:00)			
#	Session	Author	Title
1	Climate Change	Baran, Kerstin* , Steffel, B. V., Smith, K. E., Aronson, R. B., Dickinson, G. H.	Micromechanical comparison of Antarctic king crabs versus jonah crabs
2	Climate Change	Draper, Alex M. , Weissburg, M.	Impacts of warming and acidification on predator-prey interactions in oyster reefs
3	Climate Change	Mahmoud, Ahmed* , Saksena, S., Long, W. C., Swiney, K. M., Foy, R. J., Steffel, B., Smith, K. E., Aronson, R. B., Dickinson, G. H.	Effects of ocean acidification on exoskeleton mechanical properties of the snow crab, <i>Chionoecetes opilio</i>
4	Climate Change	Saksena, Sanjana* , Mahmoud, A., Long, W. C., Swiney, K. M., Foy, R. J., Dickinson, G. H.	Assessing the effects of ocean acidification on structure of the snow crab exoskeleton
5	Biological Invasions	Gray, Jeanette* , Tepolt, C. K.	Two invasive invertebrates: understanding their range limits in Northeastern North America through relative thermal tolerance
6	Biological Invasions	Hoffman, Sarah , Bologna, P.	Analysis of the spatial distribution, and recruitment of native and non-native tunicate species on <i>Zostera marina</i> in the New Jersey
7	Biological Invasions	Lewis, Shantae , Ferguson, S.	DNA extraction of <i>Halophila stipulacea</i> plants for genetic variability around the Virgin Islands
8	Biological Invasions	Lee, Timothy* , Blakeslee, A. M. H.	Diversity of parasites in the Eastern mud snail <i>Ilyanassa obsoleta</i> associated with an invasive alga <i>Gracilaria vermiculophylla</i>
9	Biological Invasions	Morrison, Blair* , Goldstein, J.	Green invaders: life stages of the European green crab (<i>Carcinus maenas</i>) in Southern Maine
10	Biological Invasions	O'Brien, Brandon , Mello, K., Litterer, A., Dijkstra, J. A.	Fish and the decline of kelp in the Gulf of Maine
11	Biological Invasions	Rodi, Anthony , Dauer, D. M.	A line in the sand: what's stopping the spread of the introduced species, <i>Hermundura americana</i> (Polychaeta: Pilargidae), throughout the Chesapeake Bay?
12	Biological Invasions	Steele, LaTina , Kebalka, M.	Patterns of amphipod feeding and phenolic content in apical and middle portions of invasive <i>Myriophyllum spicatum</i> and native <i>Ceratophyllum demersum</i>
13	Ecophysiology	Clancy, Kathleen* , Atkins, R., Osenberg, C. W.	Do physiological responses to temperature depend on body mass?
14	Ecophysiology	Thomas, Bennett* , Rees, B., Gautreaux, M., Kelly, M.	DNA sequence variation of the HIF1A gene in the Gulf killifish, <i>Fundulus grandis</i>
15	Ecosystem Functioning & Sustainability	Breaux, Natasha , Lebreton, B., Palmer, T. A., Beseres Pollack, J.	Serpulid reef communities as critical habitat for invertebrate prey resources

THURSDAY MARCH 29 - MORNING POSTER SESSION (9:00–12:00)			
#	Session	Author	Title
16	Ecosystem Functioning & Sustainability	Laurenzano, Claudia* , Nelson, J. A.	Effects of environmental change in Louisiana salt marshes on habitat use of coastal consumers
17	Ecosystem Functioning & Sustainability	Veit-Koehler, Gritta , Kusch, E., Bohn, M., Witte, U., Mayr, C., Link, H.	Antarctic benthic functioning and the role of meiofauna - a question of time?
18	Living Shorelines	Amato, Jamie* , Cebrian, J., Goff, J.	Environmentally-friendly alternatives to bulkheads for resilient and healthy shorelines: evaluation and implementation of two living shoreline designs
19	Metapopulations, Population Genetics	Allende, Maili* , Gurski, L. M., Hamilton, A. M., Hamner, R. M., Selwyn, J. D., Bird, C. E.	Microgeographic adaptations and acclimation in shell morphology of a Hawaiian limpet
20	Metapopulations, Population Genetics	Clarke, Damian G.* , Harper, F. M.	Phylogeographic analysis of the seastar, <i>Asterias forbesi</i> , in the Northwest Atlantic
21	Metapopulations, Population Genetics	Sturm, Alexis B. * , Voss, J. D.	Assessing population connectivity of the coral species, <i>Montastraea cavernosa</i> , across various spatial scales in Cuba and the Tropical Western Atlantic
22	Habitat Sustainability & Restoration	Bollinger, M. A., Maxwell, K. E., Sharp, William C.	Effects of Hurricane Irma on staghorn coral (<i>Acropora cervicornis</i>) restoration sites and a nearshore sponge community in the Florida Keys
23	Habitat Sustainability & Restoration	Chapa, Adrianna* , Martinez, M. J., Palmer, T. A., Beseres Pollack, J.	Oyster reef restoration effects on estuarine macrobenthos in St. Charles Bay, Texas
24	Habitat Sustainability & Restoration	Hanson, Grace , Goergen, E. A., Gilliam, D.	Impact of two hurricanes on an in situ <i>Acropora cervicornis</i> nursery
25	Habitat Sustainability & Restoration	Mambretti, J. M., Stelly, T. D., Gelpi, Carey G.	Fish and invertebrate community assemblages associated with a remnant, unharvested, North American oyster reef in Sabine Lake, Texas
26	Habitat Sustainability & Restoration	Moody, M., Prettyman, J., Johnson, Keith D.	Growth and survival of <i>C. virginica</i> in the Baltimore Inner Harbor
27	Habitat Sustainability & Restoration	Olsen, Z., Grubbs, Faye. , Clarkson, E., Starek, M., Berryhill, J.	Logistical considerations for the use of unmanned aerial vehicles in coastal habitat monitoring: a case study in high-resolution subaquatic vegetation assessment
28	Habitat Sustainability & Restoration	Pettis, Evan, L. Clarkson, E.	Using low-cost, recreational side-scan sonar and echosounder units to inform oyster reef restoration in Aransas Bay, Texas
29	Habitat Sustainability & Restoration	Rose, Kate* , Behringer, D. C.	Measuring trophic structure in hard-bottom habitats of the Florida Keys to determine the success of sponge community restoration

THURSDAY MARCH 29 - MORNING POSTER SESSION (9:00–12:00)			
#	Session	Author	Title
30	Habitat Sustainability & Restoration	Villalon, Brianna* , Martinez, M. J., Palmer, T. A., Beseres Pollack, J.	Oyster reef restoration effects on estuarine productivity in St. Charles Bay, Texas
31	Habitat Sustainability & Restoration	Williams, Abby* , Palmer, T., Beseres Pollack, J.	Estimating enhancement of faunal production resulting from oyster reef restoration
32	Resilience of Coastal Ecosystems	Gautreaux, Michelle , Jones, H., Thomas, B., Kelly, M.	Developing a qPCR assay to assess the tolerance of <i>Crassostrea virginica</i> to temperature and salinity stress
33	Resilience of Coastal Ecosystems	Goff, Joshua , Scheffel, W., Cebrian, J., Heck, K. L.	Effect of black mangroves (<i>Avicennia germinans</i>) on the recovery of <i>Spartina alterniflora</i> communities
34	Resilience of Coastal Ecosystems	Ledford, Taylor* , Kleinhuizen, A., Tatariw, C., Mortazavi, B.	The impact of nutrient loading on nitrate removal in a <i>Juncus roemerianus</i> and <i>Spartina alterniflora</i> dominated saltmarsh in the northern Gulf of Mexico
35	Resilience of Coastal Ecosystems	Poirrier, Michael A. , Lopez, J., Kerisit, A., Walker, C. C., Songy, A.	Benthic invertebrate zonation in a Mississippi River deltaic estuary
36	Resilience of Coastal Ecosystems	Tollette, Derek* , Tatariw, C., Mortazavi, B.	The effects of oil on northern Gulf of Mexico salt marsh nitrogen cycling
37	Resilience of Coastal Ecosystems	Zimmerman, Kelly , Bologna, P.	Assessment of eelgrass resilience and recovery following Hurricane Sandy
38	Sustainable Fisheries	Hayes, Christian T. , Darnell, M. Z., Smee, D. L., Martin, C. W., Hall, M. O., Furman, B. T., Darnell, K. M.	Nekton habitat use and habitat-specific production estimates for turtle grass across the Gulf of Mexico
39	Community Ecology	Baker, C., Frank, Colin	Distribution of lancelets, <i>Branchiostoma virginiae</i> , relative to sediments and community structure offshore from Cape Canaveral, Florida
40	Community Ecology	Hamaoui, Jr., G. S., Fachini, A., Billetz, A. C., Nielsen, H., Hilling, L., Goodwin, Anne M.	Bacterial symbionts in the sea anemones <i>Diadumene lineata</i> and <i>Exaiptasia pallida</i>
41	Community Ecology	Bernal, Erika* , Bologna, P.	Zooplankton community structure from two New Jersey estuaries
42	Community Ecology	Grace, Sean P. , Feehan, C. J.	The perils of settling in turf: reduced attachment strength of kelps and consequences for holdfast morphology
43	Community Ecology	Keyser, Spencer K.* , Yeager, L. A.	Impacts of climate-mediated mangrove expansion on avian community dynamics
44	Community Ecology	Martin, C. W., Reynolds, L. K., Scheffel, Whitney A. , Tiffany, S., Kopetman, S.	Diel shifts in fish and invertebrate community structure within Big Bend seagrass habitats

THURSDAY MARCH 29 - MORNING POSTER SESSION (9:00–12:00)			
#	Session	Author	Title
45	Community Ecology	Turner, Jessica , Snyder, M., Hilbish, J.	The turnover of space in a barnacle dominated intertidal community: the interaction of temperature and predation
46	Recruitment/Larval Ecology	Braga, Cierra* , Hunsucker, K., Gardner, H., Swain, G.	The application of ultraviolet light to control biofouling
47	Recruitment/Larval Ecology	Good, Cameron , Snyder, M., Hilbish, J.	Microgeographic variation in larval settlement and recruitment in the barnacle <i>Semibalanus balanoides</i>
48	Recruitment/Larval Ecology	Wassick, Ann* , Hunsucker, K., Swain, G.	Temporal variation in the recruitment of biofouling organisms at Port Canaveral, Florida
49	Reef Ecology	Noren, Lara* , Scott, A., Pawlik, J. R.	Is there a relationship between sponge and algal cover in the mesophotic zone of Caribbean reefs?
50	Reef Ecology	Silva-Luna, Yanelle , Mercado-Molina, A. E., Ruiz-Díaz, C. P., Sabat, A. M.	Relationship between partial mortality and the demography of the threatened coral <i>Acropora cervicornis</i>
51	Reef Ecology	Faircloth, Doug , Hicks, D., Easton, E.	Evaluating responses of benthic macrofauna to artificial reef placement in the Gulf of Mexico
52	Reef Ecology	Fogarty, N. D., Vollmer, A., Enneking, Kory	<i>Orbicella faveolata</i> coral chimeras can be visually identified based on morphological differences
53	Reef Ecology	Govert, Nicole M. , Idjadi, J. A.	Gut feelings about herbivory on coral reefs: is there an influence of diet on gut microbes and visa versa?
54	Reef Ecology	Kobelt, Julia N. , Feehan, C. J., Sharp, W. C.	Effects of Hurricane Irma on <i>Diadema antillarum</i> in the Florida Keys
55	Reef Ecology	Koerner, Sarah G.* , Fogarty, N. D., Baker, A. C., Figueiredo, J.	Timing and drivers of symbiont selection in the early life stages of the massive starlet coral <i>Siderastrea siderea</i>
56	Reef Ecology	Combs, Ian R.* , Voss, J. D.	White blotch disease impacts on corals in Southeast Florida
57	Anthropogenic Impacts	Conrad-Forrest, Nate* , Baguley, J.	Effects of the Deepwater Horizon oil spill on the meiofauna biomass in the deep-sea
58	Anthropogenic Impacts	Dauer, Daniel M. , Llansó, R. J., Lane, M. F.	Benthic community condition trends in the Chesapeake Bay – 30 years and what progress?
59	Anthropogenic Impacts	Douglass, James , Sang, A.	Direct and indirect effects of disturbance and eutrophication on SW Florida seagrasses
60	Anthropogenic Impacts	Jacinto, Kimberly E.* , Palmer, T. A., Montagna, P. A., Hyde, L. J., Sweet, S. T., Klein, A. G.	Localized anthropogenic effects on the marine environment at Palmer Station, Antarctica
62	Anthropogenic Impacts	Mast, Jessica , Greer, S., Erickson, A. A.	A proposed study to document bioaccumulation in sea urchins in the Gulf of Mexico
61	Behavior	Bartenfelder, Amy* , Jarvis, J., Kenworthy, W. J., Puckett, B.	Investigation on the grazing habits of blue crabs in temperate and sub-tropical seagrasses located on the North Carolina coast

THURSDAY MARCH 29 - MORNING POSTER SESSION (9:00–12:00)			
#	Session	Author	Title
63	Anthropogenic Impacts	Reidenbach, Leah B. * , Cottrell, D. M., Kulp, R. E., Hudson, D. M., Peterson, B. J.	The effects of ocean acidification on <i>Dyspanopeus sayi</i> predation
64	Behavior	Schabot, Elizabeth M. * , Robinson, M. P.	Diversity of UV-reflectance among damselfishes (Pomacentridae)
65	Behavior	Guidone, Michele , Collins, F.	Influence of human disturbance and marsh vegetation on fiddler crab retreat behavior
66	Conservation and Management	Canty, Rachel , Hart, J., Noble, R., Froelich, B.	More human pathogenic <i>Vibrio spp.</i> found in farmed (aquaculture) vs. wild oysters in North Carolina, USA
67	Conservation and Management	Cheripka, Alicia * , White, J. W.	Money on the move: managing shifting species through marine protected areas due to climate change
68	Conservation and Management	George, Lindsey , Clarkson, E. , Grimmett, B., Olsen, Z. , Rodney, B., Taylor, S.	Acoustic backscatter analysis of nekton utilization over restored and non-restored oyster reefs
69	Conservation and Management	Shamblott, Kaitlynn , Kamel, S.	The effect of relocation on hatching success of loggerhead sea turtle nests
70	Biodiversity	Margo, Abe * , Palmer, T., Beseres Pollack, J.	A tidal index of biotic integrity for the Texas Coast
71	Biodiversity	Pavliska, Chelsea , Hicks, D. W.	A review of octocoral distribution in the Northwestern Gulf of Mexico
72	Biodiversity	Smith, Jamie K. * , Montagna, P. A.	Multiple stressor effects on macrobenthic communities in Southeastern Corpus Christi Bay, Texas, U.S.A.
73	Benthic Ecosystem Services	Hagedorn, Samantha , Valentine, M., Butler, M. J.	Diel Nutrient Cycling by Tropical Sponges
74	Life History Strategies	Duermit, Elizabeth * , Bojko, J., Behringer, D. C.	Life history strategy and the evolution of pathogen avoidance in the Atlantic blue crab, <i>Callinectes sapidus</i>
75	Chemical Ecology	Velasquez, Marissa G. , Tettelbach, S. T.	The new fad diet: the effect of predator diet on the phenotypic plasticity of bay scallops (<i>Argopecten irradians</i>) by the common spider crab (<i>Libinia emarginata</i>)

THURSDAY MARCH 29 - AFTERNOON (1:30-3:15)			
Room	CORPUS CHRISTI BALLROOM A	NUECES BALLROOM A	NUECES BALLROOM B
Session	Reef Ecology I: Disturbance/Hurricanes/ Community Shifts	Sustainable Fisheries	Trophic Relationships
Chair	Tanya Ramseyer	Zach Darnell	Ken Heck
1:30 - 1:45	Bright, A. J. , Williams, D. E., Peterson, A. Impact of Hurricane Irma on the upper Florida Keys elkhorn coral population	Kemberling, A.* , Darnell, M. Z. Estimating presence and abundance of spawning female blue crabs offshore in the Gulf of Mexico using fishery-independent survey data	Ledet, J.* , Byrne, M., Poore, A. G. B. Diet and temperature interact to affect survival and fecundity of a marine herbivore
1:45 - 2:00	Skutnik, J. E., Otieno, S., Khoo, S. K., Strychar, K. B. Deepwater Horizon: a mesophotic coral's response to heat stress and oil	Olmi, H. D.* , Darnell, M. Z. Seasonal and spatial variation in fishing mortality of the Louisiana blue crab spawning stock	Atkins, R. L.* , Osenberg, C. Incorporating intraspecific variation and metabolic theory into our understanding of consumer-plant interactions
2:00 - 2:15	Gleason, D. F. , Harbin, L. R., Divine, L. M., Matterson, K. O. The role of larval supply and competition in controlling recruitment of the temperate coral <i>Oculina arbuscula</i>	Darnell, M. Z. , Kemberling, A., Olmi, H.D. Large-scale movements of spawning female blue crabs in the Gulf of Mexico: a Gulf-wide mark-recapture study	Pharo, D.* , Behringer, D. C. The effects of hard-bottom habitat degradation on the ecology and biology of the Florida stone crab <i>Menippe mercenaria</i> from the Florida Keys
2:15 - 2:30	Jones, N. P.* , Walton, C. J., Gilliam, D. S. Spatiotemporal change in Southeast Florida's coral reef communities in a warming ocean	Smith, C. S.* , Ito, M., Namba, M., Nakaoka, M. Oyster aquaculture changes <i>Zostera marina</i> epibiont community composition	Miller, S. D.* , Hamilton, S. L., Zgliczynski, B. J., et al. Trophic niche width expansion of coral reef fishes along a primary productivity gradient in the remote central Pacific
2:30 - 2:45	Colella, M. , Ruzicka, R., Huebner, L., Ellis, A., et al. The continuing shift from stony coral to octocoral communities in the Florida Keys	McClenachan, L. , Marra, M., Grabowski, J., Record, N., et al. Historical data reveal changing social effects of rapid temperature changes on marine fisheries over the last half century	Ziegler, S. L. , Able, K. W., Fodrie, F. J. Regional differences in trophic interactions among marsh-associated fishes
2:45 - 3:00	Huebner, L. K. , Harper, L., Ruzicka, R., Fogarty, N. D., Gleason, D. F. Variability in juvenile coral and octocoral communities in the Florida Keys	Shell, R. M.* Effects of hard clam (<i>Mercenaria mercenaria</i>) grow-out operations on benthic invertebrate community structure in Barnegat Bay, NJ.	Livernois, M. C.* , Powers, S. P., Fodrie, F. J., Heck, K. L. Habitat complexity and species assemblage shape predator-prey interactions in a model estuarine ecosystem
3:00 - 3:15	Ramseyer, T.* , Smith, T. B., Turner, T., Brandt, M. E. Effect of herbivore reduction and nutrient addition on the dynamics of the macroalgae, <i>Dictyota</i> spp. in St. Thomas, USVI	Behringer, D. C. , Butler, M. J., Muller, R. What toll does PaV1 exact from the Caribbean spiny lobster population?	Rodriguez, A.* , Heck, K. L. Juvenile green sea turtle grazing and the tropicalization of the northern Gulf of Mexico
3:15 - 3:45	BREAK CORPUS CHRISTI BALLROOM B/C		

THURSDAY MARCH 29 - AFTERNOON (3:45-5:45)			
Room	CORPUS CHRISTI BALLROOM A	NUECES BALLROOM A	NUECES BALLROOM B
Session	Reef Ecology II: Disease/Management/Genetics	Molecular Ecology	Ecosystem Functioning & Stability
Chair	Matt Nicholson	Carlos Prado	Arley Muth
3:45 - 4:00	Ruzicka, R. , Colella, M., Huebner, L., Ellis, A., et al. Devastating changes to coral populations in the Florida Keys due to an unprecedented coral disease outbreak	Prada, C. , Pollock, J. F., Lopez, T., Woodley, C., et al. Adaptive divergence along depth gradients in the common reef-building corals <i>Orbicella annularis</i> and <i>O. franksi</i>	Neal, B. P. , Williams, G. J., Work, T. M., Honisch, B., et al. Tropical reef fish herbivory controls acute outbreaks of a marine fungal pathogen
4:00 - 4:15	Hayes, N. K.* , Walton, C. J., Gilliam, D. S. White-plague like disease outbreak and mass stony coral mortality along the Southeast Florida Reef Tract	Griffiths, J.* , Kelly, M., Differential responses to ocean acidification between populations of <i>Balanophyllia elegans</i> corals from different upwelling environments	McMurray, S. E. , Stubler, A. D., Erwin, P. M., Finelli, C. M., et al. Another way to close the "loop": emergent sponges do not return detritus to Caribbean reefs
4:15 - 4:30	Hiley, A. H. , Hayes, N., Gilliam, D. S. Change in Southeast Florida octocoral density following a multi-year disease event	O'Cain, E. D. , Frischer, M. E., Harrison, J. S., Fogarty, N. D., et al. Development of a molecular assay for Caribbean coral identification	Lesser, J.* , James, W. R., Stallings, C. C., Wilson, R. M., et al. Ecosystem production drives trophic niche volume
4:30 - 4:45	Bock, M. E.* , Fogarty, N. D. Investigating pathogen transmission techniques and genotypic resistance in the staghorn coral, <i>Acropora cervicornis</i>	Gantt, S. E.* , McMurray, S. E., Stubler, A. D., Finelli, C. M., et al. Microbial Symbionts, Carbon and Nutrient Cycling in Caribbean Coral Reef Sponges	Ehrmann, H. , Olsen, C., Montagna, P. A., Palmer, T. A., Turner, E. L. Do small volumes of freshwater inflow make a difference?
4:45 - 5:00	Hightshoe, M. V.* , Miller, S., Fogarty, N. D. <i>Acropora cervicornis</i> disease transmission assays: a method for testing potential resistance and improving coral restoration practices	Lopanik, N. B. , Locklear, S., Miller, H., Lim-Fong, G. Context dependency in a cosmopolitan defensive symbiosis	Carroll, J. M. , Kelly, J. L., Bliss, T. Is groundwater a potential driver of oyster populations within Georgia creeks?
5:00 - 5:15	Powers, C. C.* , Zeeman, S. I., Fox, J., Brazeau, D., Ciaramentaro, H. Host health as a driver of symbiont uptake in <i>Exaiptasia-Symbiodinium</i> symbioses	Johnson, K. M. , Kelly, M. W. Assessing DNA methylation patterns of the Eastern Oyster (<i>Crassostrea virginica</i>) collected across coastal Louisiana	Brown, E. J. , McCaffrey, K. R., Stein, J., Viehman, S., et al. Triage following Hurricane Irma most needed at low-wave exposure sites in the Florida Keys
5:15 - 5:30	Reigel, A. M. , Miller, L. C., Reaves, R. A., Hellberg, M. E. Are phenotypic-delimitations a viable method of coral species identification in temperate Southeastern reefs?	Schuldt, M.* , Marquis, N., Fernández-Robledo, J., Kingston, S. E. Disease on the half-shell: prevalence and impact of the protistan pathogen <i>Haplosporidium nelsoni</i> on oyster population health in the Gulf of Maine	Bennett, B.* , Selwyn, J., Sylva, R., Fielding, E., et al. Community-managed, voluntary "Rest Areas" result in increased abundance of a Hawaiian shellfish
5:30 - 5:45	Nicholson, M. D.* , Sikkil, P. C. Trophodynamics of fish-parasitic gnathiid isopods on Caribbean coral reefs	Duffin, P.* , Martin, D., Lohan, K., Ross, C. Assessing prevalence and severity of seagrass wasting disease in Florida Bay as a function of immune status in the host species, <i>Thalassia testudinum</i>	Congdon, V.* , Bonsell, C., Cuddy, M., Dunton, K. H. Direct impacts to seagrass ecosystem structure in the wake of Hurricane Harvey

FRIDAY (MARCH 30) DAY AT A GLANCE			
7:00 – 8:30	CONTINENTAL BREAKFAST CORPUS CHRISTI BALLROOM B/C		
8:00 – 5:00	REGISTRATION CORPUS CHRISTI BALLROOM FOYER		
	Corpus Christi Ballroom A	Nueces Ballroom A	Nueces Ballroom B
8:30 – 10:00	Reef Ecology III: Community Ecology	Biodiversity	Benthic Ecosystem Services/ Deep Sea Biology
10:00 – 10:30	BREAK CORPUS CHRISTI BALLROOM B/C		
10:30 – 12:00	Reef Ecology IV: Larval Recruitment/ Reef Fish	Habitat Sustainability & Restoration I	Behavior
12:00 – 1:30	LUNCH ON YOUR OWN		
1:30 – 3:15	Macroecology/ Chemical Ecology/ Life History	Habitat Sustainability & Restoration II	Evolution/ Population Genetics/ Genomics
3:15 – 3:45	BREAK CORPUS CHRISTI BALLROOM B/C		
3:45 – 5:45	Recruitment/ Larval Ecology	Climate Change	Conservation Management
6:30 – 7:30	Bus transportation to Brewster's Street Icehouse		
7:00 – 10:00	AWARDS BANQUET/BAND BREWSTER STREET ICEHOUSE		
8:00 – 11:30	Bus transportation to Omni Hotel		

FRIDAY MARCH 30 - MORNING (8:30-10:00)			
Room	CORPUS CHRISTI BALLROOM A	NUECES BALLROOM A	NUECES BALLROOM B
Session	Reef Ecology III: Community Ecology	Biodiversity	Benthic Ecosystem Services/Deep Sea Biology
Chair	Joe Pawlik	Ed Proffitt	Gritta Veit-Köhler
8:30 - 8:45	Pawlik, J. R. Turnabout: bottom-up vs. top-down factors shaping community structure of sponges on Caribbean fore-reefs	Brannock, P. , Learman, D. R., Mahon, A. R., Santos, S. R., et al. Biogeography of meiofaunal communities along a 5500 km transect of Western Antarctica	Lebreton, B. , Rivaud, A., Picot, L., Prévost, B., et al. Potential flaws of ecosystem services monetary valuation: case study of intertidal bare mudflats
8:45 - 9:00	Veras, D. , Behringer, D. C., Frazer, T., Maneval, P. Influence of sponges on growth, survivorship and skeletal density of nursery-grown staghorn coral <i>Acropora cervicornis</i>	Lopez, D. P. , Freestone, A. L. Predation increases functional diversity in the tropics revealing latitudinal variation in community assembly	Jensen, A.* , Wilson Grimes, K. R., Smith, E., Brandt, M. E. Carbon storage varies by benthic seagrass habitat and site around St. Thomas, U.S. Virgin Islands
9:00 - 9:15	Olinger, L.* , Fonnegra, A. C., Enochs, I., Brandt, M. E. An evaluation of local multispecies competition among corals, sponges, and macroalgae on reefs in the U.S. Virgin Islands	Price, J. , Messing, C. G., Lopez, J., Gilliam, D. Species richness, diversity and abundance of sponge communities in Broward County, Florida, 2000-2015	Veit-Köhler, G. , Durst, S., Schuckenbrock, J., et al. Benthic meiofauna communities in Weddell Sea, Bransfield Strait and Drake Passage (Antarctic) depend on oceanographic and topographic conditions
9:15 - 9:30	Reynolds, D.* , Dixon, D., Lunz, K. S., Ross, C. The effects of the red tide producing algae, <i>Karenia brevis</i> , on <i>Porites astreoides</i> : a potential regional stressor to coral reefs	Easton, E. E. , Rodriguez, R., Hicks, D. Assessing coral assemblages inhabiting relict coral banks off the south Texas coast	Mathiske, A.* , Thistle, D., Veit-Köhler, G. Deep sea with no limits? Four new closely related species of <i>Emertonia</i> (Copepoda, Harpacticoida) from the deep sea show characters with a world-wide distribution
9:30 - 9:45	Dunn, R. P.* , Altieri, A., Hovel, K. A. Contrasting behavioral responses to predatory risk cues in sympatric Caribbean urchins	Proffitt, C. E. , Devlin, D. J., Coldren, G. A. Marsh plant identity and diversity affect mangrove recruitment, survival, and growth	Violich, M. , Grubbs, R. D., Brooks, E. The Deep-sea ecosystem: assessment of the biodiversity and abundance of deep-water fauna in the Exuma Sound, Eleuthera, Bahamas and the Northeastern Gulf of Mexico
9:45 - 10:00	Ashur, M.* , Dixon, D. Nocturnal homing in habitat-specialized reef shrimp – a function of morphological and chemical cues	Reuscher, M. G. , Montagna, P. A. Taxonomic sufficiency and unidentifiable species in multivariate biodiversity assessments of benthic polychaetes from the northern Gulf of Mexico	Tornabene, L. , Baldwin, C., Robertson, R. Beyond the mesophotic: community structure of Caribbean deep-reef fishes
10:00 - 10:30	BREAK CORPUS CHRISTI BALLROOM B/C		

FRIDAY MARCH 30 - MORNING (10:30-12:00)			
Room	CORPUS CHRISTI BALLROOM A	NUECES BALLROOM A	NUECES BALLROOM B
Session	Reef Ecology IV: Larval Recruitment/Reef Fish	Habitat Sustainability & Restoration I	Behavior
Chair	Derek Hogan	Anna Armitage	Erica Ross
10:30 - 10:45	Habicht, K.* , Fogarty, N. D., Campbell, J. Early life history response of reef building coral <i>Orbicella faveolata</i> to ocean warming and acidification	Del Rosario, E.* , McLaughlin, R., Montagna, P. Managing for a “Sound Ecological Environment”	Gutzler, B. C.* , Watson, W. H., Goldstein, J. S. Follow your heart: using dataloggers to investigate behavior in freely-moving lobsters
10:45 - 11:00	Harper, L. , O’ Cain, E., Huebner, L. K., Ruzicka, R., et al. Variability in scleractinian and octocoral recruitment along the Florida Reef Tract	Rickards, L.* , Douglass, J. Assessing seagrass responses to reduced optical water quality and other changes in Estero Bay, Florida	St-Pierre, A. P., Moreland, H. R., Gagnon, P. Body size and competitor identity modulate prey consumption and feeding behaviour in a slow-moving benthic predator (<i>Asterias rubens</i>)
11:00 - 11:15	Nyander-Asplin, H. F.* , Fogarty, N. D. Investigating population transitions from the threatened parental species, <i>Acropora cervicornis</i> , to its hybrid in the U.S. Virgin Islands	Darnell, K. M. , Furman, B. T., Heck, K. L., Dunton, K. H. Variability in shoal grass (<i>Halodule wrightii</i>) dormant seed densities across the northern Gulf of Mexico	Montagna, P. A. What have we learned from studies of offshore platforms, oil seeps, and oils spills?
11:15 - 11:30	Otte, H. A phylogeographic analysis of black coral (<i>Antipatharia</i>) on artificial and natural reefs in the Northwestern Gulf of Mexico	Yeager, L. , Congdon, V., Dunton, K. H. Degradation and resilience of seagrass community and food web structure following a direct impact by Hurricane Harvey	Lunt, J. , Boswell, J., Scherer, A. E. Do blue crabs alter eastern oyster feeding?
11:30 - 11:45	Selwyn, J. D. , Usseglio, P., Hogan, J. D. Fine-scale microhabitat usage of a putative habitat generalist reef dwelling goby, <i>Coryphopterus personatus</i>	Armitage, A. R. , Weaver, C. A., Kominoski, J. S., Pennings, S. C. Shoreline erosion and plant damage within the mangrove-marsh ecotone following Hurricane Harvey	Stubler, A. D. , Finelli, C. M. Can predator presence influence bioerosion?
11:45 - 12:00	Ames, C. A. , Smith, S. G., Walker, B. K., Kerstetter, D. W. Defining the biogeographic assemblage regions of reef fish along the Florida Reef Tract	Hart, J. E. , Bollinger, M. A., Sharp, W. C. Assessing the efficacy of in situ nurseries to support sponge community restoration	Ross, E.* , Behringer, D. C. Avoiding viruses: how does a Caribbean spiny lobster deal with PaV1 and WSSV infected conspecifics
12:00 - 1:30	LUNCH On Your Own		

FRIDAY MARCH 30 - AFTERNOON (1:30-3:15)			
Room	CORPUS CHRISTI BALLROOM A	NUECES BALLROOM A	NUECES BALLROOM B
Session	Macroecology/Chemical Ecology/Life History	Habitat Sustainability & Restoration II	Evolution/Population Genetics/Genomics
Chair	Matthew A. Whalen,	Brittany Blomberg	Jeff W. Turner
1:30 - 1:45	Whalen, M. A. , Duffy, J. E., Whippo, R., Bitemap Team (40 collaborators) Ocean Bitemap: global and local drivers of shallow water predation intensity	Blomberg, B. , Heck, K. L., Haner, J., Knight, D., et al. Lessons learned from Alabama's living shorelines	Jarrett, J. N. , Dean, N. The influence of defensive plasticity and predator patchiness on the distributions of two chthamloid barnacles
1:45 - 2:00	Freestone, A. L. , Ruiz, G. M., Jurgens, L. J., Bonfim, M., et al. Predation is stronger in the tropics in a nearshore marine ecosystem	Beseres Pollack, J. , Palmer, T., Lebreton, B., Rezek, R., et al. Lessons learned from a decade of oyster reef restoration in the Gulf of Mexico	Gossett, J. Genetic variation in the eastern oyster, <i>Crassostrea virginica</i> : analyzing kinship between spat and adults on a fine spatial scale
2:00 - 2:15	Vlasak, T. , Tettelbach, S. T., Peterson, B. J., Kulp, R. E. Stinky snails: chemical cues of <i>Crepidula fornicata</i> and their effect on the forging ability of chemosensory predators	Martinez, M. J.* , Palmer, T., Beseres Pollack, J. The effects of a restored oyster reef (<i>Crassostrea virginica</i>) on estuarine nekton and infauna	Hamilton, A.* , Lopez, A., Larkin, P. D. How 'Clone' can you go? Seagrass genotypic diversity at three different sampling scales
2:15 - 2:30	Butler, C. B. , Butler, J., Matthews, T. R. The hunger games: how starvation affects attractiveness of the live bait lobsters and trap catch in the Florida spiny lobster fishery	Rodney, W. Oyster reef restoration results in enhanced fish species richness according to scientific angling results	Bird, C. E. , Hamilton, A., Allende, M., Hamner, R. M. Origins of a fourth lineage in the adaptive radiation of Hawaiian 'opihi
2:30 - 2:45	O'Neil, L. , Kight, S., Prezant, R. Density and feeding dependence effects on life history of <i>Sphaerium simile</i>	Conser, E.* , Shanks, A. Algal density on rocky shores varies with surfzone width	Hilbish, J. , Burrell, A. Integration of natural selection across the life-cycle stabilizes a marine mussel hybrid zone
2:45 - 3:00	Cunningham, C. Do echinoderms senesce?	Le Corre, N. , Pepin, P., Han, G., Ma, Z. Impact of biological variables on larval dispersal of benthic-pelagic species	Eckert, R. J.* , Studivan, M. S., Voss, J. D. Breaking point: population genetics reveal a lack of vertical connectivity of <i>Montastraea cavernosa</i> on the Belize Barrier Reef
3:00 - 3:15	Matsumoto, Y. , Miglietta, M. P. Reverse development in <i>Turritopsis dohrnii</i> (immortal jellyfish): model system for regeneration, cellular plasticity and aging	Schaefer, N.* , Mayer-Pinto, M., Johnston, E. L., Dafforn, K. A. Characterizing the ecological assemblages of urban rock pools: implications for ecological engineering	Elledge, N. C.* , Pinnell, L. J., Turner, J. W., Eytan, R. I. Genomic discovery of ecotype-specific features in <i>Serratia marcescens</i> associated with acroporid serratiosis
3:15 - 3:45	BREAK CORPUS CHRISTI BALLROOM B/C		

47th Annual Benthic Ecology Meeting Program

Bold is presenting author. Only first four coauthors listed. * Is judged in student presentation competition.

FRIDAY MARCH 30 - AFTERNOON (3:45-5:45)			
Room	CORPUS CHRISTI BALLROOM A	NUECES BALLROOM A	NUECES BALLROOM B
Session	Recruitment/Larval Ecology	Climate Change	Conservation Management
Chair	Ben Belgrad	Ben Walther	Zachary Olsen
3:45 - 4:00	Zyck, A. H.* , Good, C., Burrell, A., Moloney, C., et al. Conflicts in scale: temporal and spatial variation in larval settlement and post-settlement growth in marine mussel populations	Carlton, D. , Mitchell, J., Fauci, A. El Niño drives a larval bottleneck for coral reef fish	Olsen, Z. , Anderson, J., Wagner, T., Sutton, G., et al. A shell of its former self: investigating drivers of the Texas blue crab fishery decline
4:00 - 4:15	Belgrad, B. A. Changes in crab zoeae composition and timing in a southeastern estuary 1982-2017: responses to climate change and seasonal variability	Walther, B. , Altenritter, M. A. Rates and consequences of sublethal hypoxia exposure for demersal fish in the northern Gulf of Mexico quantified with geochemical markers	Rassweiler, A. , Lauer, M., Schmitt, R. J., Lester, S. E., et al. How does fishing change in response to ecological shifts on a Polynesian coral reef?
4:15 - 4:30	Feehan, C. J. , Grauman-Boss, B. C., Strathmann, R. R., et al. Kelp detritus provides high-quality food for sea urchin larvae	Sadler, D. E. , Lemasson, A. J., Knights, A. M. Altered beasts: changes in biological functioning of predator and prey under ocean acidification	Hesley, D. , Burdeno, D., Drury, C., Schopmeyer, S., et al. Citizen science benefits coral reef restoration activities
4:30 - 4:45	Favitta, W. , Wahle, R., Reardon, K., Brown, C., Lemieux, N. Revealing deepwater lobster settlement across thermal gradients in the Gulf of Maine	Varnerin, B. V.* , Gleason, D. F. Impacts of ocean acidification on recruits of the temperate coral <i>Oculina arbuscula</i>	Firth, L. B. , Harris, D., Blaze, J., Bordeyne, F., et al. The way that we went: biogeography and historical ecology of the ecosystem engineer <i>Sabellaria alveolata</i> in Ireland
4:45 - 5:00	Yao, N.* , Zhang, Y. Investigating the connectivity of Florida Caribbean spiny lobster <i>Panulirus argus</i> recruits using stable isotope analysis	Dickinson, G. H. , Nardone, J. A., Patel, S., Siegel, K. R., et al. Assessing the impacts of ocean acidification on adhesion and shell formation in the barnacle <i>Amphibalanus amphitrite</i>	Sheehan, E. , Rees, A., Bridger, D., Holmes, L., Atrill, M. J. The Lyme Bay MPA Case Study: benthic recovery, storm impacts and lessons learnt
5:00 - 5:15	Hogan, J. D. , Trejo, A., Downey-Wall, A. Determining habitat use in juvenile lionfish: addressing the nursery hypothesis	Paulus, E.* , Robinson, M. P. Acidification slows withdrawal reflex in sea hares (<i>Aplysia californica</i>), a potential sub-lethal effect of anthropogenic climate change	Clarkson, E. , Olsen, Z. Large-scale oyster restoration in Texas: a legislative mandate, and the science behind it
5:15 - 5:30	Kough, A. , Belak, C. A., Paris, C. B., Cronin, H., et al. Scenic SCUBA surveys suggest spillover sustains some snails: over-exploited queen conch populations replenished by marine protected area	Kelly, M. W. , Griffiths, J. G. Linkage with maladapted alleles restrains evolutionary rescue via gene flow in a tide pool copepod	Wilber, D. , Peterson, M., Slack, T. Predicting benthic foraging habitat for Gulf sturgeon throughout the Gulf of Mexico
5:30 - 5:45	Sutton, G. R. , Pronker, L.. Modeling blue crab growth	Cammarata, K. , Roberson, W., Brislawn, C., Everett, E., Hare, S. <i>Halodule wrightii</i> epiphyte microbiome response to fertilization and/or grazer inhibition	Peterson, B. J. , Lowell, A. V.; Wallace, R. B. Seagrass OASIS: Ocean Acidification Sanctuaries and Subsidies
7:00 - 10:00	AWARDS BANQUET BREWSTER STREET ICE HOUSE		

LOCATIONS OF PREVIOUS BENTHIC MEETINGS

#	Year	Location (City)	Host Institution(s)	Meeting Organizer(s)
1	1972	Durham, NH	University of New Hampshire	Larry Harris
2	1973	Beaufort, NC	Duke University	John Sutherland
3	1974	College Park, MD	University of Maryland	Sally Woodin
4	1975	Beaufort, NC	Duke University	John Sutherland
5	1976	Baltimore, MD	Johns Hopkins University	Sally Woodin, Jeremy Jackson
6	1977	Newhaven Ct	Yale University	Don Rhodes, Allen Michael
7	1978	College Park, MD	University of Maryland	Gary Vermeij
8	1979	Durham, NH	University of New Hampshire	Larry Harris
9	1980	Williamsburg, VA	Virginia Institute of Marine Science	Don Boesch, Bob Diaz
10	1981	New Haven, CT	Yale University	Don Rhodes, Leo Buss, Nancy Knowlton
11	1982	Boston, MA	Harvard University	Ken Sebens and Ruth Turner
12	1983	Melbourne, FL	Florida Institute of Technology, University of South Florida	Walter Nelson, Susan Bell, Bob Virnstein
13	1984	Towson, MD	Goucher College, Martin-Marietta	Fred Holland, Anna Shaughnessy, Robert Diaz and Bill Johnson
14	1985	Columbia, SC	University of South Carolina	Bob Feller, Steve Stancyk, David Wetthey
15	1986	Boston, MA	U. Mass Boston	Gene Gallagher, Mike Rex, John Ebersole
16	1987	Raleigh, NC	North Carolina State University, University of North Carolina, Duke University	Lisa Levin, John Sutherland, Mark Hay
17	1988	Portland, ME	University of Maine	Bob Steneck, Les Watling
18	1989	Solomons, MD	University of Maryland	Ken Tenore, Don Rice
19	1990	Mobile, AL	Marine Environmental Science Consortium, DISL	Ken Heck, Loren Coen, Steve Morgan
20	1991	Williamsburg, VA	Virginia Institute of Marine Science, Old Dominion University	Bob Orth, Dan Dauer
21	1992	Newport, RI	University of Rhode Island, Brown Univ	Stan Cobb, Steve Gaines
22	1993	Mobile, AL	Marine Environmental Science Consortium, DISL, University of South Alabama	Ken Heck, Loren Coen, Jon Pennock, John Valentine
23	1994	Mystic, CT	University of Connecticut, University of New Haven, Northeast Utilities Environmental Lab, Mystic Marinelifelife Aquarium, Mystic Seaport/Williams College Program	Bob Whitlatch, Roman Zajac, Jim Carlton, Rich Malatesta, Joyce Rodriguez

47th Annual Benthic Ecology Meeting Program

#	Year	Location (City)	Host Institution(s)	Meeting Organizer(s)
24	1995	New Brunswick, NJ	Rutgers University	Judy Grassle, Aline Kelsey, Ellen Oats, Paul Snelgrove
25	1996	Columbia, SC	University of South Carolina	Sally Woodin, Dennis Allen, Stephen Stancyk, Judy Williams-Howze, Robert Feller, David Wetthey, Dean Pentcheff, Thomas Chandler, Alan Decho, Bruce Coull
26	1997	Portland, ME	University of Maine	Bob Steneck, Phil Yund, Will Ambrose, Rick Wahle, Amy Johnson and Bob Vadas
27	1998	Melbourne, FL	Florida Institute of Technology, US EPA, University of South Florida, St. Johns River Water Management District, University of Central Florida, Florida Marine Research Institute	Junda Lin, Walter Nelson, Susan Bell, Robert Virnstein, Linda Walters, Margaret Hall
28	1999	Baton Rouge, LA	LSU and Louisiana Sea Grant	Kevin Carman, Kenneth Brown, John Fleeger, Robert Carney, Darryl Felder, Nancy Rabalais
29	2000	Wilmington, NC	UNC - Wilmington	Joe Pawlick, Martin Posey
30	2001	Durham, NH	University of New Hampshire	Larry Harris
31	2002	Orlando, FL	Florida State University	David Thistle, Don Levitan, William Herrnkind
32	2003	Mystic, CT	University of Connecticut	Bob Whitlatch, Joyce Wood-Martin
33	2004	Mobile, AL	Dauphin Island Sea Lab	John Valentine, Ken Heck
34	2005	Williamsburg, VA	Virginia Institute of Marine Science	Rochelle Seitz, Rom Lipcius
35	2006	Quebec City, Canada	University Laval	Ladd Johnson, Mathieu Cusson
36	2007	Atlanta, GA	Georgia Tech	Mark Hay
37	2008	Providence, RI	University of Connecticut	Sandy Shumway
38	2009	Corpus Christi, TX	Texas A&M University-Corpus Christi	Paul Montagna (Chair), Jennifer Beseres Pollack, Terry Palmer, Lee Smee
39	2010	Wilmington, NC	UNC - Wilmington	Joe Pawlick, Chris Finelli, Martin Posey
40	2011	Mobile, AL	Dauphin Island Sea Lab	Sean Power, John Valentine, Ken Heck
41*	2012*	Norfolk, VA*	Old Dominion University	Mark Butler
42	2013	Savannah, GA	Georgia Southern University	Daniel Gleason
43	2014	Jacksonville, FL	University of North Florida	Matthew Gilg, Cliff Ross
44	2015	Québec City,	University Laval	Ladd Johnson, Mathieu Cusson
45	2016	Portland, ME	Bowdoin College	David Carlon
46	2017	Myrtle Beach, SC	Coastal Carolina University	Keith Walters
47	2018	Corpus Christi, TX	Texas A&M University-Corpus Christi	Lee Smee (Chair), Paul Montagna, Donna Devlin, Jennifer Beseres Pollack, Ed Proffitt

* BEM becomes an official society.

BEMS CODE OF CONDUCT

Registration for the Benthic Ecology Meeting is considered an agreement to abide by the Code of Conduct.

The Benthic Ecology Society is committed to providing a safe, productive, and welcoming environment for all meeting participants including attendees, speakers, volunteers, vendors, staff, and service providers. All participants are expected to:

- Treat others with respect and consideration
- Communicate openly, remembering to critique ideas and not individuals
- Avoid personal attacks toward others
- Respect posted rules and policies of the meeting venue
- Avoid harassment of any participant. Harassment includes but is not limited to unwanted verbal attention, unwanted touching, intimidation, stalking, shaming, or bullying. Harassment presented jokingly is still harassment and is not acceptable. Retaliation for reporting harassment is unacceptable as is reporting an incident in bad faith.
- Discrimination or harassment on the basis of gender or gender identity, sexual orientation, age, disability, physical appearance, race, religion, national origin, or ethnicity will not be tolerated.

Consequences

- Anyone asked to stop unacceptable behavior is expected to comply immediately.
- BEM may ask anyone violating the Code of Conduct to leave the meeting. In this circumstance, registration refunds will not be offered. Offenders may be banned from future BEM meetings.

Reporting

- If you wish to report unacceptable behavior please notify anyone at the registration desk or email bem@tamucc.edu
- Anyone witnessing behavior that represents an immediate threat to public safety should contact a security guard or locate a house phone and ask for security to make a report.

BEM 2018 CONFERENCE NOTES

Restaurants - Downtown Corpus Christi



VENUE MAPS

OMNI BAYFRONT – WORKSHOPS, PLENARY, AND ORAL SESSIONS

FIRST FLOOR

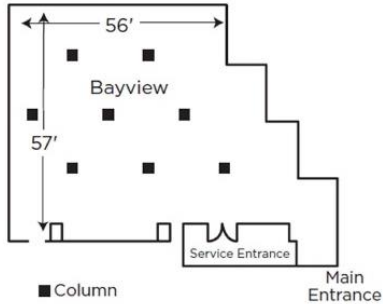

THIRD FLOOR

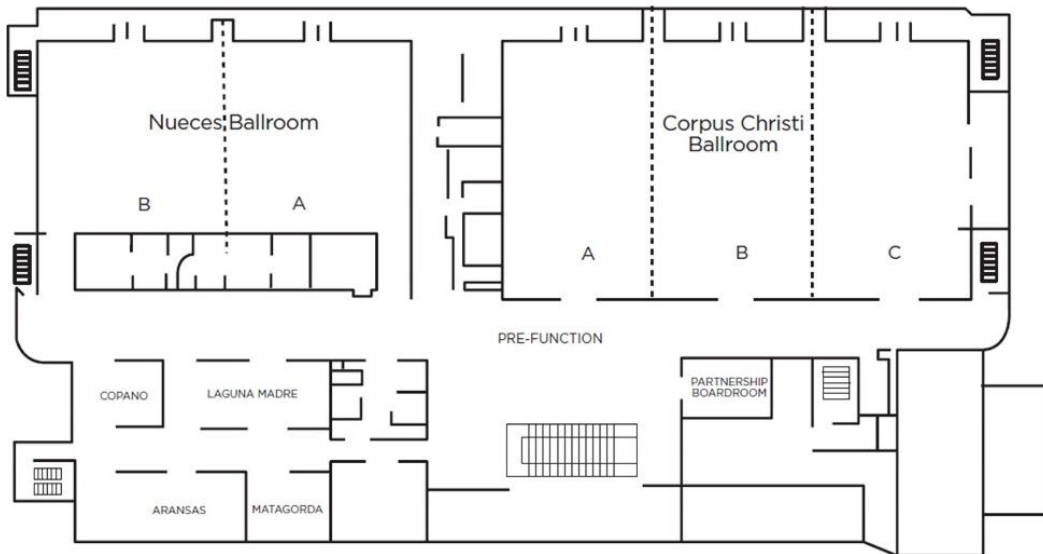

TEXAS STATE AQUARIUM – POSTER SESSION

